

EVENT LOCATIONS & FULL SERVICE

MEETINGS

INCENTIVES

CONVENTIONS

EVENTS



OLYMPIAWORLD

EVENT LOCATIONS, INCOMING & FULL SERVICE

The various locations of the Olympiaworld Innsbruck offer unique conditions for hosting individual MICE highlights for customers and employees and provide solutions for companies of all sectors and sizes. From an exclusive event for a small group of guests to major events with up to 10,000 people – almost everything is possible. The premises allow flexible and customisable solutions to meet all requirements.

The Olympiaworld has an impressive location advantage and is conveniently situated for visitors from all over the world due to its direct motorway access and more than 1,000 parking spaces, the nearby railway station and the international airport, which is only 15 minutes away.

Together with partners, our Olympiaworld team has been successfully organising and hosting events of all sizes and kinds for many years. This includes taking over all necessary tasks in logistics and hospitality as well as providing spectacular supporting programmes amidst the magnificent panorama of the Alps. Moreover, we will be happy to handle the entire destination management for you. Whenever you require support or seek strong partners, we will stand by your side with a great deal of experience, competence and passion.



Olympic flame

The Olympic flame has already been lit three times in Innsbruck: in 1964 and 1976 for the Olympic Winter Games and in 2012 for the Youth Olympic Winter Games. Every event hosted in the Olympiaworld benefits from the Olympic spirit, sporting mindset and big emotions that are inherent in important competitions.

Sustainability

Sustainability plays a key role in all services the Olympiaworld offers to congress participants and business travellers. Thereby, the Olympiaworld is encouraging the development of Tyrol from a congress destination to a green meeting destination: At all times, the Olympiaworld acts in a sustainable and caring manner, holding events in accordance with the highest ecological standards.

Quality

The Olympiaworld Innsbruck adheres to highest quality standards. To improve the operation of the buildings and their technical facilities as well as internal processes a quality management system was developed and certified according to the ISO 9001 standard.



CHRISTMAS PARTIES

PRESENTATIONS

GALA DINNERS

CONVENTIONS

EXHIBITIONS

WORKSHOPS

INCENTIVES

BANQUETS

MEETINGS

SEMINARS

AWARDS

EVENTS

FAIRS



OVERVIEW & ROOM CAPACITIES

Unique top location up to 10,000 PAX

The Olympic Hall with a capacity of up to 10,000 PAX is the heart of the Olympiaworld. The extraordinary top location provides not only space for 10,000 people but also has a special atmosphere. Besides the Olympic Hall, the Olympiaworld offers a variety of other attractive venues – some of them truly unusual. All of them meet the most modern standards and thus are suited for events of all kinds and sizes.

You can choose between the seven-metre elevated VIP lounges in the Tivoli Stadium, the marvellous foyer, the café directly at the Olympic ice track, the TIWAG Arena with its impressive architecture and many other venues. No matter how classic or extraordinary the ideas for your event are, the Olympiaworld will have the right setting to realise them!

Also, when it comes to providing sustenance, the Olympiaworld is perfectly prepared. While our in-house F&B facilities can cater small events, we work with various trusted partners to provide catering for large events. Catering is not only possible in the Sportsbar with its exclusive premium lounge and the Bobcafé K14 but also in all other event venues.

Why choose the Olympiaworld?

1. PERFECT INFRASTRUCTURE
Direct motorway access; international airport and railway station in the vicinity
2. FLEXIBLE PREMISES
Ranging from intimate rooms to large, spectacular halls to the outdoor area
3. MICE FULL SERVICE
Professional organisation and hosting of events of all kinds and sizes
4. GREAT SELECTION OF HOTELS
Guaranteed availability of hotels of all classifications in Innsbruck and the surrounding area
5. APPEALING SETTING
First-class possibilities for side-events in both urban area and Alpine setting

	Room(s)	Area m²	Capacity people seated/standing
1 Olympic Hall (floor & grandstands)	1	2.500 (without grandstands)	800–10.000
2 Olympic Hall Foyer A–D	4	1,040	80–900
3 Panorama West & East	2	300	50–300
4 Multi-purpose Hall	1–4	480	20–350
5 6 Tivoli VIP rooms	2	500	50–350
7 Sportsbar	1	250	max. 110
8 Premium Lounge	1	150	max. 70
9 Bobcafé / Olympic Ice Track	1	250	max. 150
10 TIWAG Arena	1	2,000 (without grandstands)	600–3,000
11 Outdoor Arena	OPEN AIR	10,000	max. 30,000 (standing)
12 Landessportzentrum	34 rooms (double and triple rooms)		



Download the venue plans:
www.olympiaworld.at/en/mice/



1 OLYMPIC HALL



Capacity

800–4,000 people (floor)
10,000 people (floor and grandstands)



Area

Floor max. 2,500 m²
Incl. ancillary rooms max. 6,000 m²



Especially suited for

congresses, conferences & conventions
sports events & cultural events
fairs & exhibitions
galas & award ceremonies
Christmas or company parties

Modern and multifunctional, equipped with sophisticated technical and infrastructural facilities, the Olympic Hall offers a unique stage for events of all kinds and sizes. Event managers will have full rein: With the 2,500 m² floor and the broad range of ancillary rooms, a total area of 6,000 m² is available. When combining floor and grandstands, up to 10,000 guests can be welcomed. The fixed and mobile grandstands offer great flexibility. Moreover, 95 suspension points in the ceiling allow outstanding possibilities.

		WITHOUT SEATING	THEATRE	CLASSROOM	ROWS OF TABLES	BANQUET	Details + venue plans
Olympic Hall (WITH GRANDSTANDS)	Concert, other events	10,000	8,000	-	-	-	
Olympic Hall (WITHOUT GRANDSTANDS)	Concert	4,000	2,000	-	-	-	
	Congress	-	2,000	800	-	-	
	Galadinner	-	-	-	1,400	1,000	

EXAMPLE THEATRE LAYOUT, STAGE SOUTH + RIGGING

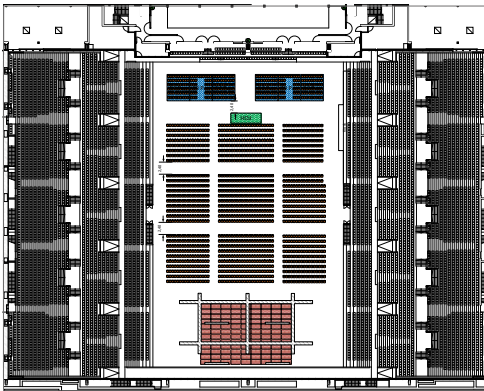

EXAMPLE BANQUET LAYOUT EAST

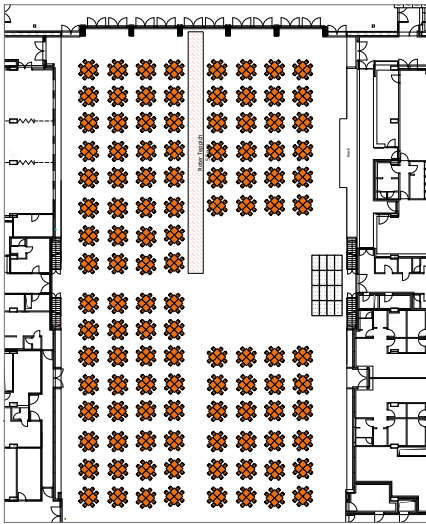

Equipment

Tables	Stage elements	Additional facilities (e.g. crowd barriers, coat racks, couches, red carpet)	95 suspension points in the ceiling	Projection equipment (projector, projector screen, microphone, loudspeaker)
Chairs	Mobile grandstands	Pre-rig truss	Equipment for suspension (suspension elements, Molton)	Modern communication technology



Contact & inquiries

Olympia Sport- und Veranstaltungszentrum Innsbruck GmbH
Olympiastraße 10
6020 Innsbruck
Austria
Phone: +43 (512) 33838-800, fax: -200
mice@olympiaworld.at



2 OLYMPIC HALL FOYER A



Capacity

100 – 320 people with seating

600 people without seating



Area

430 m²



Especially suited for

fairs & exhibitions

promotions





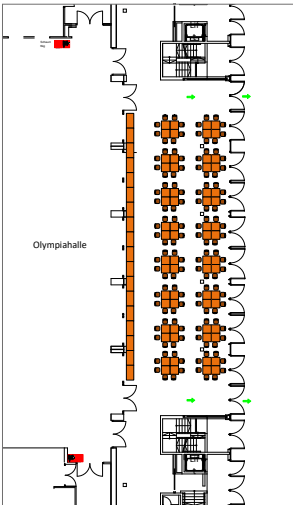

product presentations

Foyer A is located on the ground floor and directly adjacent to the Olympic Hall. It is the largest of all ancillary rooms in the north annex of the hall. When major events are hosted, the room serves as an entrance and waiting area. However, thanks to its considerable size and brightness, Foyer A has become a popular venue for exhibitions, promotions or product presentations.



EXAMPLE BANQUET LAYOUT



	 WITHOUT SEATING	 THEATRE	 CLASSROOM	 ROWS OF TABLES	 BANQUET	Details + venue plans
Olympic Hall FOYER A	600	320	100	170	130	



Equipment



Tables & chairs, mobile bar, couches



Additional facilities (e.g. crowd barriers, coat racks, red carpet)



Projection equipment (projector, projector screen, microphone, loudspeaker)

2 OLYMPIC HALL FOYER B



Capacity

80 – 300 people with seating

500 people without seating



Area

260 m²



Especially suited for

seminars & conferences

company meetings & plenary assemblies





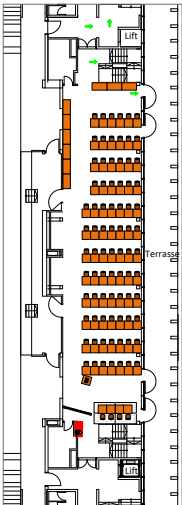

workshops & working groups

Foyer B is located on the first floor and offers everything you need for a conference or an annual general meeting. The window front on the north side provides brightness without direct sun exposure. Moreover, the terrace adjacent to the room invites you to take relaxing breaks in the fresh air.



EXAMPLE CLASSROOM LAYOUT



	 WITHOUT SEATING	 THEATRE	 CLASSROOM	 ROWS OF TABLES	 BANQUET	Details + venue plans
Olympic Hall FOYER B	500	300	80	160	120	



Equipment



Tables & chairs, mobile bar, couches



Additional facilities (e.g. crowd barriers, coat racks, red carpet)



Projection equipment (projector, projector screen, microphone, loudspeaker)



Contact & inquiries

Olympia Sport- und
Veranstaltungszentrum Innsbruck GmbH
Olympiastraße 10
6020 Innsbruck
Phone: +43 (512) 33838-800, fax: -200
mice@olympiaworld.at

2 OLYMPIC HALL FOYER C + D



Capacity

80 – 300 people with seating

450 – 650 people without seating



Area

120 m² – 230 m²



Especially suited for

ceremonies & award shows

seminars & conferences





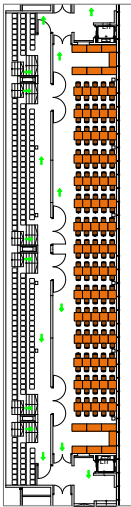

Christmas & company parties

With its spatial openness, the foyer on the second floor spreads a dignified, festive atmosphere. In memory of the 1964, 1976 and 2012 Winter Games, the Olympic rings rise up on the long, high window front. Is there any better place to honour a person for an extraordinary achievement?



EXAMPLE ROWS OF TABLE LAYOUT



	 WITHOUT SEATING	 THEATRE	 CLASSROOM	 ROWS OF TABLES	 BANQUET	Details + venue plans
Olympic Hall FOYER C	450	300	80	150	100	
Olympic Hall FOYER D	200	-	-	40	-	



Equipment



Tables & chairs, mobile bar, couches



Additional facilities (e.g. crowd barriers, coat racks, red carpet)



Projection equipment (projector, projector screen, microphone, loudspeaker)

3 PANORAMA WEST & EAST



Capacity

50 – 140 people with seating per room

300 people without seating per room



Area

150 m² per room



Especially suited for

product presentations

workshops & working groups





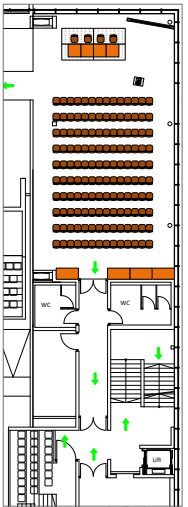

parties in an extraordinary ambience

The two rooms on the second floor adjoin Foyer C to the west and east. They have two outstanding features: first, the breathtaking view of the Nordkette mountain range and second, their great height and open design, which allow the rooms to be flooded with light. All in all: the perfect setting for presenting new products or enhancing creative thinking processes.



EXAMPLE THEATRE LAYOUT



	 WITHOUT SEATING	 THEATRE	 CLASSROOM	 ROWS OF TABLES	 BANQUET	Details + venue plans
Panorama West	300	140	50	100	80	
Panorama East	300	140	50	100	80	



Equipment



Tables & chairs, mobile bar



Additional facilities (e.g. crowd barriers, coat racks, red carpet)



Projection equipment (projector, projector screen, microphone, loudspeaker)



Contact & inquiries

Olympia Sport- und
Veranstaltungszentrum Innsbruck GmbH
Olympiastraße 10
6020 Innsbruck
Phone: +43 (512) 33838-800, fax: -200
mice@olympiaworld.at

4 MULTI-PURPOSE HALL



Capacity

100 – 350 people with seating

1,000 people without seating



Area

485 m²; can be divided into up to 4 rooms

Separate rooms:
65 m² – 120 m²



Especially suited for

smaller exhibitions

breakout sessions





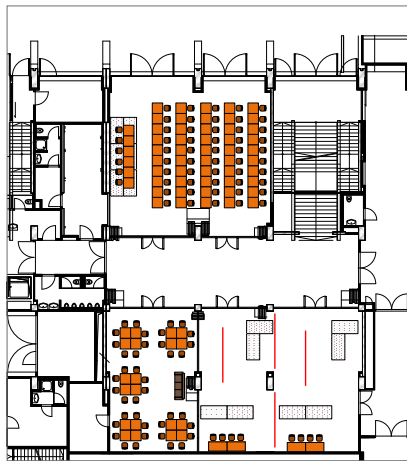

meetings, workshops & seminars

The 485 m² multi-purpose hall on the ground floor, right next to the Olympic Hall, offers a quiet, intimate atmosphere. Therefore, it is particularly suitable for seminars, workshops or breakout sessions, where participants can recharge their batteries and gain new energy. When major events are hosted in the Olympic Hall, the multi-purpose hall offers a great separate venue for side events or areas for various visitor groups (e.g. children's area) – away from the hustle and bustle but yet close. Thanks to mobile partition walls, the shape and size of the multi-purpose hall can easily be adjusted. If required, it can be divided into up to four individual rooms of 65 m² to 120 m².



SEATING EXAMPLE



	 WITHOUT SEATING	 THEATRE	 CLASSROOM	 ROWS OF TABLES	 BANQUET	Details + venue plans
Multi-Purpose Hall	1.000	350	100	180	140	



Equipment



Tables & chairs,
mobile bar,
couches



Additional facilities
(e.g. crowd barriers, coat racks,
red carpet)



Projection equipment
(projector, projector screen,
microphone, loudspeaker)

5 TIVOLI VIP NORTH



Capacity

50 – 130 people with seating

150 people without seating



Area

150 m²



Especially suited for

congresses, conferences & meetings

seminars, workshops, VIP dinners & banquets





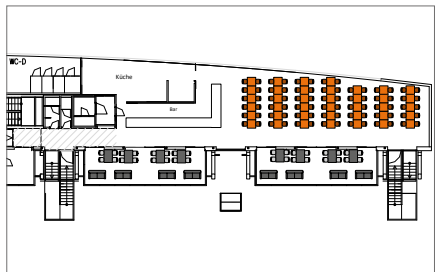

(larger) breakout sessions

The high, light-flooded rooms with a typical stadium flair provide the ideal setting for corporate events with style. Within the traditional building, the two spacious VIP lounges offer modern premises for various occasions. Located on one level, VIP North and South present a total of 500 m² of usable space. During major events, the separated rooms are often used to cater for VIP guests. Of course, the lounges can also be rented individually for events of all kinds. You can choose between various seating options from theatre to banquet layout.



EXAMPLE ROWS OF TABLES LAYOUT



	 WITHOUT SEATING	 THEATRE	 CLASSROOM	 ROWS OF TABLES	 BANQUET	Details + venue plans
Tivoli VIP North	150	130	50	110	70	



Equipment



Tables & chairs,
mobile bar,
couches



Additional facilities
(e.g. crowd barriers, coat racks,
red carpet)



Projection equipment
(projector, projector screen,
microphone, loudspeaker)



Contact & inquiries

Olympia Sport- und
Veranstaltungszentrum Innsbruck GmbH
Olympiastraße 10
6020 Innsbruck
Phone: +43 (512) 33838-800, fax: -200
mice@olympiaworld.at

6 TIVOLI VIP SOUTH



Capacity

60 – 210 people with seating

350 people without seating



Area

350 m²



Especially suited for

smaller exhibitions
breakout sessions
meetings, workshops & seminars

The Tivoli Stadium was built in 2000 and has made a name for itself, at least since the 2008 UEFA European Football Championship. A true eyecatcher is its VIP area in a two-floor glass building floating seven metres above the sky. Both Tivoli VIP South and Tivoli VIP North are well-known and sought-after in the event scene. The exclusive premises allow a unique view of the pitch and space for all kinds of events. Good to know: The lounges can also be booked in the football off-season.



EXAMPLE CLASSROOM LAYOUT

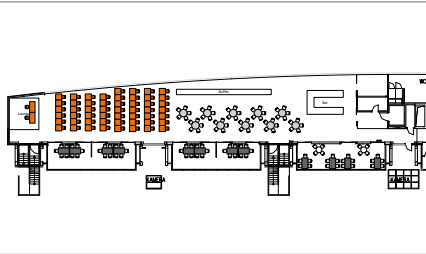

	WITHOUT SEATING	THEATRE	CLASSROOM	ROWS OF TABLES	BANQUET	Details + venue plans
Tivoli VIP South	350	170	60	210	180	

7 SPORTSBAR



Capacity

110 people



Area

250 m²



Especially suited for

fair, event & conference catering
seminars, workshops & VIP dinners
(larger) breakout sessions

Located right between the Olympic Hall and TIWAG Arena, the Sportsbar offers a cosy atmosphere for lunch and dinner rich in variety. The Sportsbar and its adjoining outdoor seating area are open to the public but can also be booked for events. For an even more exclusive setting, the adjacent Premium Lounge is a great choice: It is a popular location for providing participants of corporate events or VIP guests with catering.



EXAMPLE SEATING LAYOUT

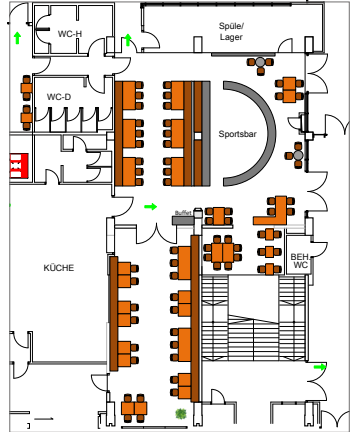

	WITHOUT SEATING	THEATRE	CLASSROOM	ROWS OF TABLES	BANQUET	Details + venue plans
Sportsbar	-	-	-	110	-	



Equipment



Tables & chairs, bar, high tables & bar chairs



Flatscreen TV sets with sports broadcast



Projection equipment (projector, projector screen, microphone, loudspeaker)



Contact & inquiries

Olympia Sport- und Veranstaltungszentrum Innsbruck GmbH
Olympiastraße 10
6020 Innsbruck
Phone: +43 (512) 33838-800, fax: -200
mice@olympiaworld.at

8 PREMIUM LOUNGE



Capacity



Area



Especially suited for

70 people

150 m²





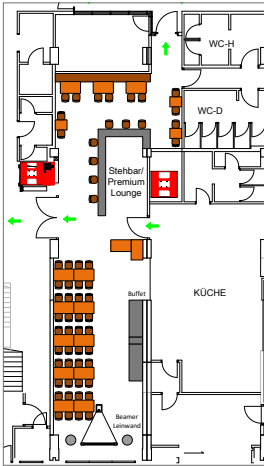

catering for visitors of public events (e.g. fairs)
catering for participants of workshops, seminars, advanced training courses & conferences
catering for VIPs
smaller company & family celebrations

If you are looking for exclusivity, the Premium Lounge in the Olympic Hall right next to the Sportsbar is the place of choice. It is a little bit smaller – and hence more intimate – than the Sportsbar next door. What makes this venue so special, is the welcoming, friendly and comfortable ambience. Some spots even have a view of the ice hall! In major events, the Premium Lounge is frequently used for welcoming VIP guests. Additionally, the lounge has already served as a venue for lunch breaks with catering during conferences, breakout sessions, coworking, bar camps and more.



EXAMPLE SEATING LAYOUT



	 WITHOUT SEATING	 THEATRE	 CLASSROOM	 ROWS OF TABLES	 BANQUET	Details + venue plans
Premium Lounge	-	-	-	70	60	



Equipment



Tables & chairs, bar, high tables & bar chairs



Flatscreen TV sets with sports broadcast



Projection equipment (projector, projector screen, microphone, loudspeaker)

9 BOBCAFÉ K14 AT THE ICE TRACK



Capacity



Area



Especially suited for

up to 160 people

250 m²





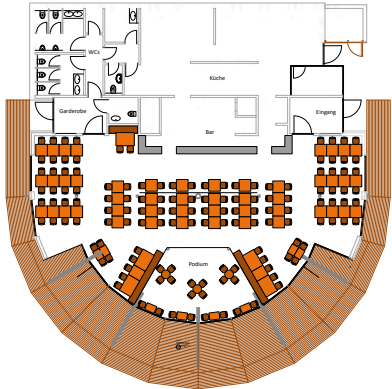

Christmas parties & company celebrations
incentives combined with a ride down the ice track

Located directly at the final curve of the Olympic Ice Track, the Bobcafé K14 in Innsbruck-Igls presents a both unique and exclusive event location. Its most distinctive features are the idyllic surrounding and the magnificent view of the Inn Valley and the Nordkette mountain range. Providing space for up to 150 people, the Bobcafé K14 invites you to host events of all kinds – from dinners and celebration to corporate events. For more action, events can be spiced up with a ride down the ice track in a special bobraft or taxi bobsled.



EXAMPLE SEATING LAYOUT



	 WITHOUT SEATING	 THEATRE	 CLASSROOM	 ROWS OF TABLES	 BANQUET	Details + venue plans
Bobcafé K14	-	-	-	150	-	



Equipment



Tables & chairs



Bar, high tables & bar chairs



Projection equipment (projector, projector screen, microphone, loudspeaker)



Contact & inquiries

Olympia Sport- und Veranstaltungszentrum Innsbruck GmbH
Olympiastraße 10
6020 Innsbruck
Phone: +43 (512) 33838-800, fax: -200
mice@olympiaworld.at

10 TIWAG ARENA



Capacity

Grandstands: 3,000 people
(21 sectors on two levels) with a seating capacity of 1,400

In addition: floor for up to 600 people



Area

Floor: 60 m² x 30 m²
usable hall area,

max: 2,000 m²



Especially suited for

sports events





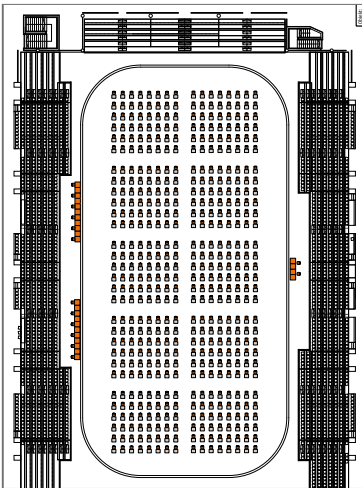

celebrations in a sporting ambience

The TIWAG Arena presents itself as a visionary glass ice palace with an amazing view of the Nordkette mountain panorama. It is an architectural highlight – both inside and outside. With a total area of 2,000 m², the arena offers all possibilities for conferences or celebrations. The grandstands are the perfect place to watch large-scale product presentations or shows. Moreover, separate VIP lounges and state of the art infrastructure – from the admission and ticket system to innovative equipping including full-glass boards and multimedia cubes – are provided. The arena has everything successful events need and, like all premises, is accessible for visitors with disabilities.







EXAMPLE SEATING LAYOUT



	 WITHOUT SEATING	 THEATRE	 CLASSROOM	 ROWS OF TABLES	 BANQUET	Details + venue plans
TIWAG Arena	-	3.000–3.600	600	600	600	



Equipment

 Floor loading: 500 kg/m²	 20 suspension points (max. point load: 800 kg)	 Power: 0,5 MW	 Light deflection system for daylight operation	 Power rating floodlight: 138 kW
--	--	---	--	---

11 OUTDOOR ARENA



Capacity

up to 30,000 people (standing)



Area

10.000 m²



Especially suited for







big open-air concerts

big corporate events with sporting activities

sports events

In winter, Austria's only open-air speed skating rink is used for public ice skating and skating events. In summer, however, the arena unfolds its full potential: Then, the large, open area hosts concerts, major events, celebrations and parties of all kinds. Spectacular open-air concerts of superstars like P!nk and David Guetta have already taken place here and attracted thousands of people. A great bonus for large-scale events is that the entire venue is bounded by a fence, allowing event organisers to overview, manage and control the large area. There are no limits to the imagination, the huge free space is just waiting to be used. Additionally, the entire infrastructure of the Olympiaworld is available – a dream come true for all event planners!



	 WITHOUT SEATING	 THEATRE	 CLASSROOM	 ROWS OF TABLES	 BANQUET	Details + venue plans
Outdoor Arena	30.000	-	-	-	-	



12 LANDESSPORTZENTRUM



Capacity

12 double rooms (8 of them accessible for wheelchairs)

22 triple rooms



Accommodation option especially for

congress, conference & convention staff

sports clubs & associations

organising committees & staff

stagehands

With 34 comfortable and bright rooms, the hotel in the Tyrolean Landessportzentrum offers affordable accommodation directly at the event area. Most rooms are equipped with a sitting area, Wi-Fi, cable channels and multi-channel TV as well as a private bathroom. Regardless of whether you are looking for a place to rest after an event or excessive sightseeing trip, everyone – from event visitors to professional athletes to city tourists – is welcome here. Moreover, the Landessportzentrum is accessible for persons with physical disabilities. The price includes not only breakfast but also the chance to run into World and European Champions who frequently train here.

Parking spaces are available for our hotel guests.

Half or full board for groups is possible on request. Check-in during the week from 2 p.m. to 10 p.m.

With the in-house competition hall, swimming hall and gym with various equipment, the hotel is perfectly suited for national and international sports clubs and teams. Moreover, the cheerleading hall is only 100 m away, and the nearby Olympiaworld offers perfect training conditions. Not only for athletes, but also for event staff and organising committees the hotel provides a convenient accommodation in easy walking distance to the Olympic Hall.



Equipment & services



Bathroom with shower and WC



Flatscreen TV set, cable connection



Free Wi-Fi



Free baggage storage



Accessibility



Contact & inquiries

Olympia Sport- und
Veranstaltungszentrum Innsbruck GmbH
Olympiastraße 10
6020 Innsbruck
Phone: +43 (512) 33838-800, fax: -200
mice@olympiaworld.at

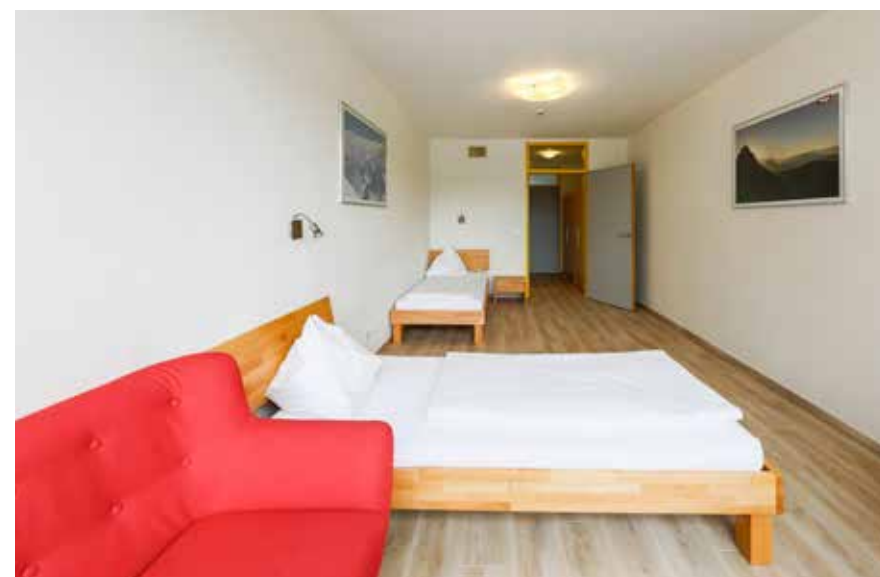

PROFESSIONAL FULL SERVICE

All in one

The Olympiaworld is more than just a venue. Together with reliable Tyrolean partners, the Olympiaworld team offers a comprehensive range of services – especially in the MICE sector. We support companies from all over the world in organising individual events – of course, always with a strong focus on sustainability. You can rely on our experience and expertise and benefit from our large network in and around Innsbruck. From the invitation to the arrival to the accommodation of your guests to planning, realising and evaluating the event itself and its framework programme – we are on hand with help and advice whenever you need support or a strong partner.

Our services at a glance

PLANNING & CONCEPTION	FAIR CONSTRUCTION
IMPLEMENTATION & EVENT MANAGEMENT	CATERING
INCOMING, HOSPITALITY, LOGISTICS & SHUTTLE SERVICE	MEDIA SERVICES OF ALL KINDS
ENTERTAINMENT, SHOWS & MUSIC	PERSONNEL SERVICES (HOSTESSES, SECURITY)
TECHNICAL EQUIPMENT	EVENT & GUEST MANAGEMENT
FURNITURE & DECORATION	EVALUATION



Incoming

If you book our incoming service, the Olympiaworld Innsbruck team will deal with destination management and take care of your Olympiaworld programme. We are happy to handle the coordination and organisation of your event, including planning, selecting a suitable technical company and making suggestions for hotels and side events. If required, one of our experienced staff members will accompany and advise you during location checks.



Hospitality

We are happy to organise your guest-related services and put you and your visitors in the centre of attention. On request, we will for example hire and instruct hostesses, welcome your guests already at the airport (or railway station or car park) and take care of accreditation, cloakrooms, and the reception. Furthermore, we can provide qualified security staff and exclusive VIP services.

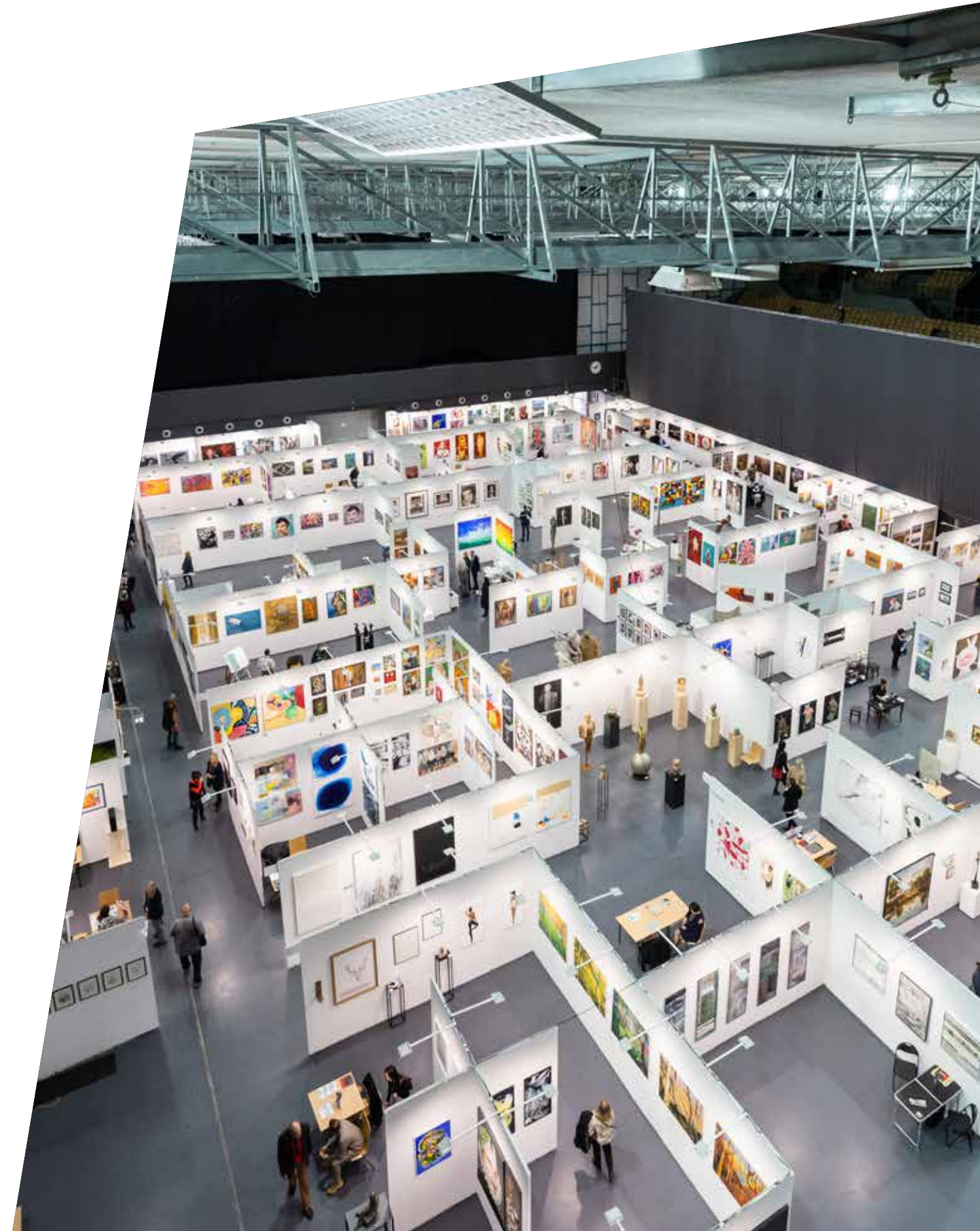

SUPPORTING PROGRAMME IN & AROUND INNSBRUCK

Spectacular side events

If you want to inspire your congress or conference participants with an extraordinary supporting programme, the Olympiaworld is the right choice for you. Thanks to the multifaceted attractions of the city of Innsbruck and its Alpine surroundings, there are countless possibilities for attractive side events. Whether sportive, creative, relaxing and entertaining or playful – we will find the right activity for you. Share your ideas with us and we will be happy to present suggestions individually tailored to your wishes and the number of participants. Choose the perfect options for your event – and upon request, we will take care of the organisation and implementation.



Bob rafting down the Olympic Ice Track in Igls

The Olympic Ice Track allows your guests to experience the fascination of sliding sports and the thrill of bob rafting, bob racing, or summer bobsleigh at first hand. Bob rafting means racing down the ice track with up to 95 km/h. From the World Cup start, the 1,270 m ice track with 14 curves and the spectacular Kreisel, a 270-degree circular curve, await the brave ones. Afterwards, the wild ride is celebrated in the Bobcafé K14, the perfect location for extraordinary incentives or teambuilding events.



Ice skating or ice stock sport in the Olympiaworld

The TIWAG Arena, the glass ice palace of the Olympiaworld, allows your guests to experience very special incentives. With expert guidance, they can learn figure skating or improve their skills. Concentration is also required in ice stock sport – a popular winter sport and booming activity for corporate events. Fun and entertainment are always part of the game. Afterwards, you can celebrate or have a drink in the Sportsbar or Premium Lounge.



Golf Performance Center

Perhaps you and your guests would like to improve your golf handicap? The Olympiaworld's Golf Performance Center with its highly professional indoor training area is the perfect place for this purpose. It is suited for every level. The facility uses state-of-the-art training equipment such as the famous Trackman technology, which is the gold standard of the world's best golfers. With this equipment, you will definitely have a lot of fun and improve your golf – or maybe even give this fantastic sport a try for the first time.



Social evening in one of the numerous huts in and around Innsbruck

Allow your guests to experience pure Alpine romance! A mountain hut evening can either stand for itself or round off an action-packed incentive. In any case, your guests can look forward to a cosy hut ambience, traditional food in a stunning setting and hearty music. On request, we will extend our entertainment programme or provide a shuttle service.



Find
all events & activities on:
<https://www.innsbruck.info/en/>



Patscherkofel

The Patscherkofel mountain is Innsbruck's ski and hiking paradise in the south and easily recognisable because of its rounded shape and the prominent transmission tower on the summit. The locals have a special connection to their backyard mountain, which looks back on an eventful history. The Patscherkofel was in the centre of attention in the 1964 and 1976 Olympics, when the thrilling, legendary Alpine ski races and competitions in the ice track took place here. If you spend your holidays here in Igls (or Innsbruck), you will definitely benefit from tested and approved host qualities.



Bergisel Ski Jump Stadium and visit to the Tirol Panorama museum

On a professionally guided tour, your guests can enjoy the breathtaking view of Innsbruck, experience the fascination of the ski jumping venue and discover the modern architecture of the Bergisel ski jump created by star architect Zaha Hadid. Afterwards, the Bergisel Sky restaurant with its magnificent panorama terrace invites you to dine. Later, we recommend a visit to the giant panoramic painting in the Tirol Panorama museum, which offers a fascinating 360-degree view of the third Bergisel battle in 1809.



Innsbruck's Nordkette at 2,300 m above sea level

The Innsbrucker Nordketten cable cars will take your guests right from the city centre up to the Hafelekar, the TOP OF INNSBRUCK, in just a few minutes. It is located in Austria's largest nature park, the Karwendel Nature Park. Hence, it is not unusual that visitors might catch a glimpse of the otherwise shy wild animals. The amazing 360-degree view with the Capital of the Alps on one side and the Karwendel Nature Park on the other leaves lasting impressions. Also, the Alpenzoo, Europe's highest themed zoo, is well worth a visit and easily accessible thanks to the Hungerburgbahn funicular.



Themed tour through Innsbruck's old town

How about a walk through the medieval old town? Here visitors stroll in the footsteps of great princes and baroque rulers. At the same time, visitors can learn interesting facts about Innsbruck's eventful history and discover almost every sight. Exciting anecdotes bring the past to life. So, if you want to get to know Innsbruck, a themed tour through the old town with a guide is always a great idea.



Gala dinner in the Swarovski Crystal Worlds

A paradise of sparkling crystal glass, a glittering fantasy world for both the young and the grown-ups, a unique art and adventure park for all senses: Millions of people have already visited the Crystal Worlds, a one-of-a-kind sight created by multimedia artist André Heller on behalf of Swarovski. Having dinner here is a delightful highlight. We can arrange all details for an unforgettable experience for your guests, including a visit to the garden of the Giant and the Chamber of Wonders with their exhibitions.

OVERNIGHT STAY

HOTELS OF ALL CLASSES

Flexible accommodation for your guests

Accommodating hundreds of guests poses a great challenge for companies organising events, especially if they are unfamiliar with the area. The Olympiaworld team can assist you with selecting and booking suitable rooms or even entire hotels for you. Numerous hotels of all classes can be found in Innsbruck and its surrounding area: from modern, convenient city centre hotels to exclusive wellness hotels to traditional mountain huts.

Please consider that booking hotels for large events with a great number of guests requires a certain amount of time in advance. After all, Innsbruck is a magnet for visitors from all over the world, especially in the high season. Fortunately, we benefit from great contacts and will do everything to make even the impossible possible.



Selection of hotels & accommodations

Near Olympiaworld	Near Olympic Ice Track (Igls)	Innsbruck city centre/ surroundings
Landessportzentrum Tirol www.olympiaworld.at/en/the-arenas/state-sport-centre/	Hotel Bon Alpina Igls *** www.bon-alpina.at	AC Hotel by Marriott **** www.marriott.com/innac
Tivoli Hotel Innsbruck *** www.tivolihotel.at	Hotel Sonnenhof *** www.sonnenhof-igls.at	Stage 12 – Hotel by Penz **** www.stage12.at
Hotel Leipziger Hof **** www.leipzigerhof.at	Sporthotel Igls **** www.sporthotel-igls.com	Hotel Innsbruck **** www.hotelinnsbruck.com
aDLERS Design Hotel **** www.adlers-innsbruck.com	Römerhof Garni www.roemerhof-igls.at	Austria Trend Hotel Congress Innsbruck **** www.austria-trend.at
IBIS Hotel Innsbruck *** www.ibis.hotels-in-tyrol.com	Isserwirt Lans *** www.isservirt.at	The Penz Innsbruck **** www.the-penz.com
Motel One**** www.motel-one.com	Landgasthof Wilder Mann **** www.wildermann-lans.at	Interalpen Hotel Tyrol ***** www.interalpen.com
B(l)ackhome City Appartments www.blackhome.at	Der Walzl **** www.gasthof-walzl.at	Alpin Resort Sacher ***** www.sacher.com/seefeld

TRANSPORT CONNECTIONS

OLYMPIAWORLD

Unique infrastructure for best accessibility

Whether by airplane, car or train – there are different ways to reach Innsbruck and the Olympiaworld quickly and conveniently. With more than 1,000 parking spaces, its own motorway access, the nearby railway station and the international airport only 15 minutes away, the Olympiaworld has a unique location advantage in terms of accessibility. In Europe, there is no other event location of this size that is that easily reachable by all three important means of transport.



By plane

The international airport in the western part of Innsbruck is approached by about 50 different airlines each year. There are daily flights to Frankfurt and Vienna. The Olympiaworld is only about 15 minutes away by taxi. Alternatively, you can take the busses of the Innsbruck public transport (IVB): first bus line F, then bus line T, which runs directly to the Olympiaworld. Of course, we can also arrange a shuttle service for you.



By car

Coming from the west or east, you can reach the Olympiaworld via the A12 motorway. Take the exit Innsbruck Mitte and then follow the signs at the roundabout for the city centre (Zentrum). On the left-hand side of the main road, you will see the Tivoli football stadium and the Olympiaworld event halls.

Coming from the south, you can reach the Olympiaworld via the A13 motorway. Take the exit Innsbruck Süd and follow the main road (Brenner Bundesstraße B 182) in the direction to Innsbruck. At the intersection with Egger-Lienz-Straße, turn right. After crossing the Olympia Bridge, you will see the Olympiaworld event halls on the right-hand side of the road.



By bus & train

The train takes you to Innsbruck main station comfortably and without stress. From there, the Olympiaworld is only a stone's throw away: five to ten minutes by taxi, depending on the traffic situation. You can also reach the Olympiaworld by public transport via the line 505. We can also organise a shuttle service for you on request.



Parking facilities

The Olympiaworld area provides more than 1,000 parking spaces directly at the site; half of them in the underground car park.

Car park Olympiahalle West	450 parking spaces
Underground car park Tivoli Stadium	550 parking spaces
Car park Landessportzentrum	100 parking spaces

